

Model: _____ Item #: _____ Date: _____

Project: _____ Qty: _____ Approved By: _____

Liquor Display



18-24RD Shown
Available in 1800 or 2100 Series

Glass Washing Cabinet



18-GW2 Shown
Available in 1800 or 2100 Series

Standard Features

BOTH UNITS

- Backsplash:
22 gauge stainless steel
- Sides:
18 gauge stainless steel
- Legs:
1-5/8" tubular 16 gauge galvanized steel with grey plastic bullet foot

LIQUOR DISPLAY ONLY

- Bottle Steps:
20 gauge embossed stainless steel
- Guard Rails:
20 gauge stainless steel with sound-deadened plastic
- Back:
20 gauge galvanized steel

GLASS WASHING CABINET ONLY

- Sink Bowl:
20 gauge stainless steel 10" x 14" x 6" deep bowl with drain
- Drainboard, Back, and Bottom:
20 gauge stainless steel
- Front Apron:
24 gauge stainless steel
- Plumbing:
1-1/2" IPS drain connection
- Faucet:
1800 Series: 4" center wall mount faucet
2100 Series: 4" center deck mount faucet

Optional Accessories

- | | |
|---------------|--|
| 30-160 | Perforated Dump Basket |
| C-36 | Upgrade: Stainless Steel Legs |
| C-39 | Right End Side Splash |
| C-40 | Left End Side Splash |
| H-109 | Upgrade: Royal Series Faucet |
| "-LC" | Stainless Steel Locking Cover for Liquor Display
(add "-LC" to end of model number of Liquor Display) |





Standard Series Underbar

Liquor Displays & Glass Washing Cabinets

Model: _____ Item #: _____ Date: _____

Project: _____ Qty: _____ Approved By: _____

1800 Series: Liquor Displays

Model	Length (A)	Steps	Approx. Bottles	Weight (lbs.)
18-12RD	1'-0"	4	12	35
18-18RD	1'-6"	4	20	35
18-24RD	2'-0"	4	24	35

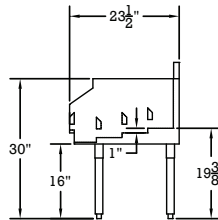
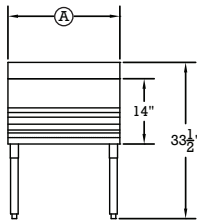
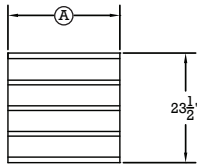

2100 Series: Liquor Displays

Model	Length (A)	Steps	Approx. Bottles	Weight (lbs.)
21-12RD	1'-0"	4	12	35
21-18RD	1'-6"	4	20	35
21-24RD	2'-0"	4	24	35

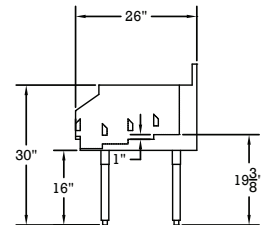
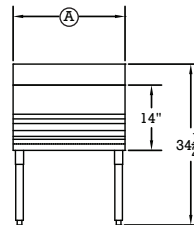
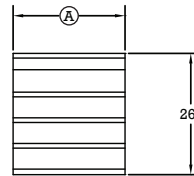

1800 Series: Glass Washing Cabinets

Model	Length	Top	Weight (lbs.)
18-GW2	2'-0"	Drainboard	35

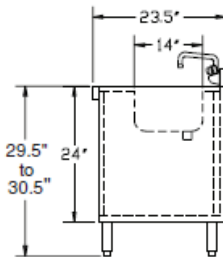
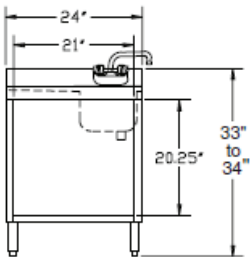
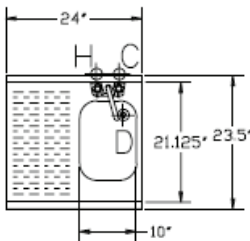

2100 Series: Glass Washing Cabinets

Model	Length	Top	Weight (lbs.)
21-GW2	2'-0"	Drainboard	35

