

ESTABLISHING A **NEW STANDARD** IN THE COMMERCIAL REFRIGERATION INDUSTRY.

WITH ITS **LARGE DISPLAY** CAPACITY, THIS THREE DOOR COOLER IS ONE OF THE LARGEST AND **MOST VERSATILE** IN THE MARKET.



➤ KEY FEATURES

• **BMAB Refrigeration System**

Ensures rapid and effective cabinet cool down and maintains consistent temperature range with minimum energy consumption

• **Electronic Temperature Controller**

Assures the optimal performance of the cooler, delivering product temperature ideal for consumption.

• **High Efficiency Glass Door**

Equipped with double panel glass and low-e film to reduce condensation. Door hinge is equipped with a self-closing system to ensure the door closes safely, and returns to original position, without any damages.

• **LED Lighting System**

Our LED system uses a fraction of the energy of regular fluorescent lights and requires no replacement for up seven years.

• **CFC and HFC Free Cyclopentane Foam**

Eco-friendly, recyclable and high efficiency cabinet insulation.

• **Electronic Fan Motors**

Enhances performance and efficiency. Uses only a fraction of the energy than industry standard shaded-pole motor requires. Longer lifespan fan motor.

ESTABLISHING A **NEW STANDARD** IN THE COMMERCIAL REFRIGERATION INDUSTRY.

PRODUCT VIEWS

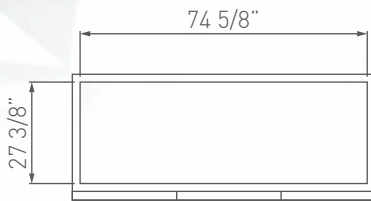

TOP VIEW

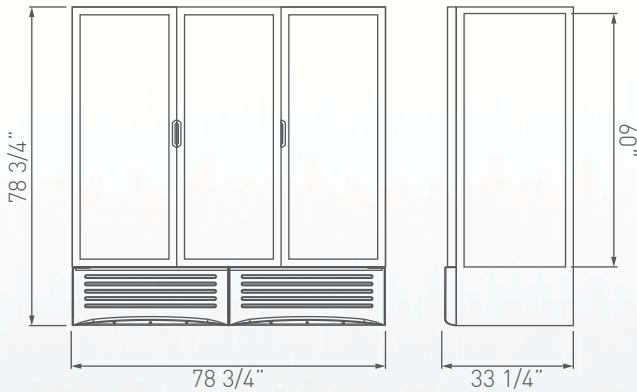

FRONT VIEW

SIDE VIEW

Warranty:

Three year limited warranty on all parts and labor, an additional two year warranty on compressor. (USA and Canada only)

Dimensions rounded up to the nearest inch or millimeter. Specifications subject to change without notice.

Customer Service: 866-363-0079 | WWW.IMBERAFOODSERVICE.COM

TECHNICAL SPECIFICATIONS

Exterior Dimensions	W:	78 3/4"	2000 mm
	D:	33 1/4"	845 mm
	H:	78 3/4"	2000 mm

Interior Dimensions	W:	74 5/8"	1897 mm
	D:	27 3/8"	694 mm
	H:	60"	1525 mm

Dimensions w/packaging	W:	81 1/8"	2060 mm
	D:	35 7/8"	910 mm
	H:	82 5/8"	2100 mm

Shelf Size	W:	21 1/2"	547 mm
	D:	24 1/8"	612 mm

Weight		665.3 Lbs	301.8 kg
Weight w/packaging		688.3 Lbs	312.2 kg

Shelves		15	
----------------	--	----	--

Capacity 20oz.	Flat:	840	
-----------------------	--------------	-----	--

REFRIGERATION DATA

Energy Consumption	9.615 kWh/day
---------------------------	---------------

Voltage	115/60
----------------	--------

Horse Power	1/3
--------------------	-----

AMPS	13.8
-------------	------

LOGISTIC

Trailer Loads	40':	12
	53':	18

Certifications	UL:	✓
	UL/EPH:	✓

* Energy consumption based on ANSI/ASHRAE Standard 72-2005.

BMAB System (Low maintenance high benefit).
Dimensions rounded up to the nearest inch or millimeter.
Specifications subject to change without notice.