



PROJECT

ITEM NO:

QUANTITY:

Dish Cabinet With Hinge Door

FEATURES & CONSTRUCTION:

- Top is fabricated with 1- 1/2" bull nose front edge, flat edges at rear and both sides.
- All exposed welded areas smooth polished to brush finish sanitary #4.
- 1-5/8" stainless steel legs with adjustable bullet feet.
- Stainless steel hinge door(s) with recessed pull handle and magnetic door catcher, optional keyed door lock available.
- Reinforced hat channel support for top, intermediate shelf and bottom shelf.
- Stainless steel pilasters allow for adjustable middle shelf.
- All units shipped K.D., but easily assembled.

MATERIAL:

Top: 16 Ga. stainless steel - 304
 Body: 18 Ga. stainless steel - 304
 Shelf: 18 Ga. stainless steel - 304
 Door: 18 Ga. stainless steel - 304
 Leg: 1-5/8" stainless steel with 2" adjustable stainless steel bullet feet



NSF STD.2
 Certified

MODEL#		UNIT SIZE		
W/O DOOR LOCK	WITH DOOR LOCK	L	D	H
SMDC-3018H	SMDC-3018HL	18"	30"	35 1/2"
SMDC-3030H	SMDC-3030HL	30"		
SMDC-3036H	SMDC-3036HL	36"		
SMDC-3048H	SMDC-3048HL	48"		
SMDC-3060H	SMDC-3060HL	60"		
SMDC-3072H	SMDC-3072HL	72"		



SMDC-3018H



SMDC-3048HL

Note: Keyed door lock are optional

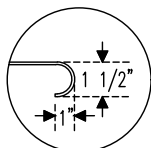
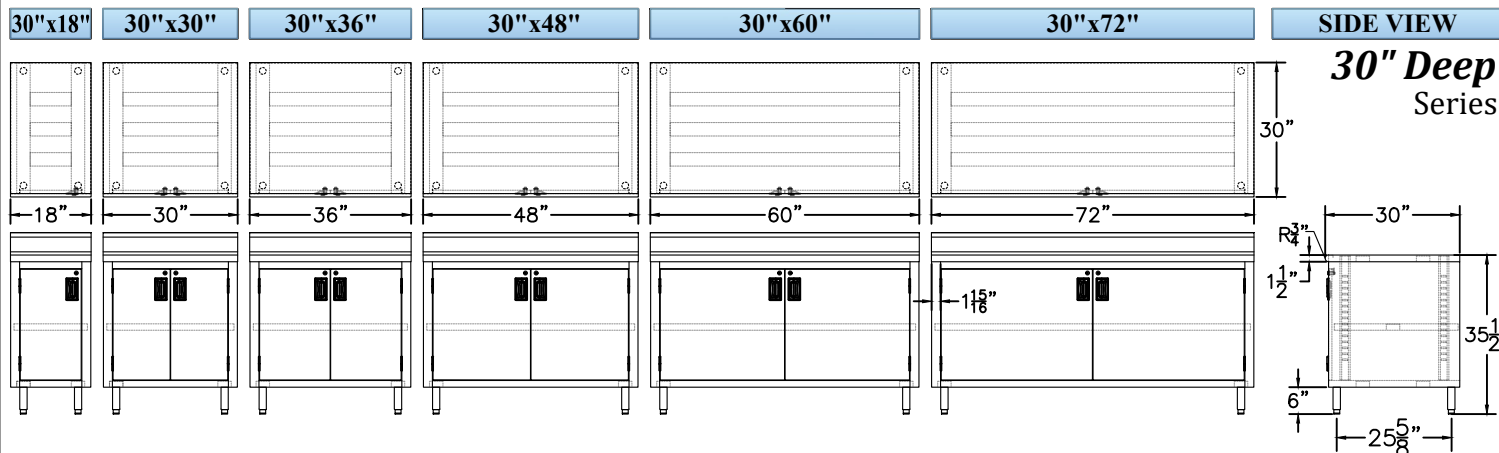

Bull Nose
Edge Front

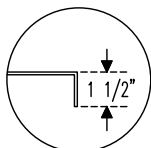

Flat Edge at Rear
And Both Sides



S/S. Pilasters for
Adj. Middle Shelf



S/S. Lift-Off
Hinges



Key Lock
Optional



S/S. Recessed
Pull Handle



S/S. Bullet Feet
2" Adjustable

Specifications subject to change without notice.

All dimensions are typical (Tolerance 1/2").



Rev. 11/22

SAPPHIRE MANUFACTURING
 Tel: 718-543-2111
 Fax: 718-543-2121

info@sapphiremanufacturing.com
 WWW.SAPPHIREMANUFACTURING.COM