



PROJECT _____

ITEM NO: _____

QUANTITY: _____

Wall Mounted Hand Sink

FEATURES & CONSTRUCTION:

- Sink is fabricated with raised edge to reduce water dripping and 8-1/2" high backsplash.
- Coved corner sink bowl with 3/4" radius.
- All exposed welded areas smooth polished to brush finish sanitary #4.
- Wall mounting clip included.
- Accessories included: faucet and strainer

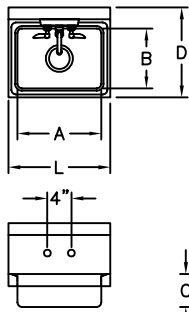

MATERIAL:

20 Ga. Stainless Steel - 304



NSF Certified

MODEL#	UNIT SIZE			BOWL SIZE		
	L	D	H	A	B	C
SMHS-01	17"	15"	14"	14"	10"	5 1/2"

Wall Mounted Hand Sink With Side Splashes

FEATURES & CONSTRUCTION:

- Sink is fabricated with raised edge to reduce water dripping and 8-1/2" high rear and side splash guard.
- Coved corner sink bowl with 3/4" radius.
- All exposed welded areas smooth polished to brush finish sanitary #4.
- Wall mounting clip included.
- Accessories included: faucet and strainer

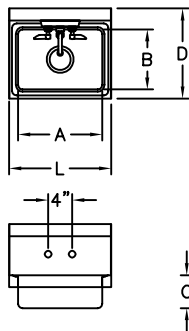

MATERIAL:

20 Ga. Stainless Steel - 304



NSF Certified

MODEL#	UNIT SIZE			BOWL SIZE		
	L	D	H	A	B	C
SMHS-01-D	17"	15"	14"	14"	10"	5 1/2"

Specifications subject to change without notice.

All dimensions are typical (Tolerance 1/2").



SAPPHIRE MANUFACTURING
Tel: 718-543-2111
Fax: 718-543-2121

Rev. 11/16

info@sapphiremanufacturing.com
WWW.SAPPHIREMANUFACTURING.COM