



PROJECT

ITEM NO:

QUANTITY:

Mop Sink

FEATURES & CONSTRUCTION:

- Sink is fabricated with flat top edge and 1" high backsplash.
- All sink bowls have covered corner with 3/4" radius.
- All exposed welded areas smooth polished to brush finish sanitary #4.
- Wall mounting bracket included.
- Accessories included: Strainer



2" IPS Drain With Strainer Included

MATERIAL:

Sink Bowl: 16 Ga. Stainless Steel - 304



NSF Certified



SMMS-251



SMMS-252

MODEL#	UNIT SIZE			BOWL SIZE		
	L	D	H	A	B	C
SMMS-251	25"	21"	10"	20"	16"	6"
SMMS-252			16"			12"

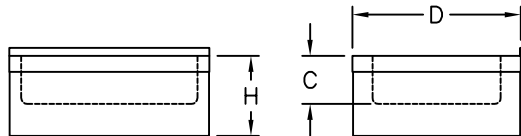
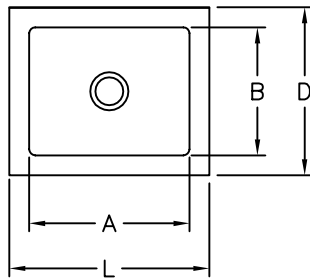

SMMS-331

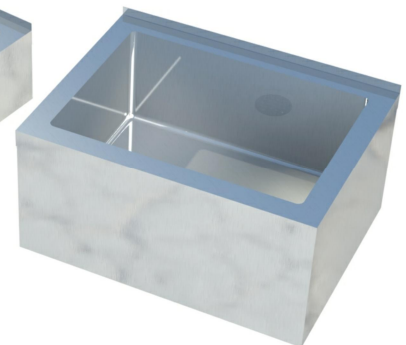

SMMS-332

MODEL#	UNIT SIZE			BOWL SIZE		
	L	D	H	A	B	C
SMMS-331	33"	25"	10"	28"	20"	6"
SMMS-332			16"			12"

Specifications subject to change without notice.

All dimensions are typical (Tolerance 1/2").



SAPPHIRE MANUFACTURING
Tel: 718-543-2111
Fax: 718-543-2121

info@sapphiremanufacturing.com
WWW.SAPPHIREMANUFACTURING.COM

Rev. 11/16